

TOTAL EXTENT (AS PER DOC.) = 5354Sq.M ✓  
 ROAD AREA = 1702Sq.M ✓  
 TOTAL NO. OF PLOTS = 22Nos. ✓

**NOTE:**



1. SPLAY - 1.5M x 1.5M
2. MEASUREMENTS ARE INDICATED EXCLUDING SPLAY DIMENSIONS
3. ROAD AREA WAS HANDED OVER TO THE LOCAL BODY VIDE GIFT DEED DOC.NO: 3558/2018, DATED:22.03.2018 @ SRO, KUNRATHUR ✓

**CONDITION**

**DR RULE No: 29 (11):**

THE COST OF LAYING IMPROVEMENTS TO THE SYSTEMS INRESPECT OF ROAD, WATER SUPPLY, SEWERAGE, DRAINAGE OR ELECTRIC POWER SUPPLY THAT MAY BE REQUIRED AS ASSESSED BY THE COMPETENT AUTHORITY, SHALL BE BORNE BY THE APPLICANT.

**LEGEND**

-  SITE BOUNDARY
-  ROADS GIFTED TO THE LOCAL BODY
-  EXISTING ROAD

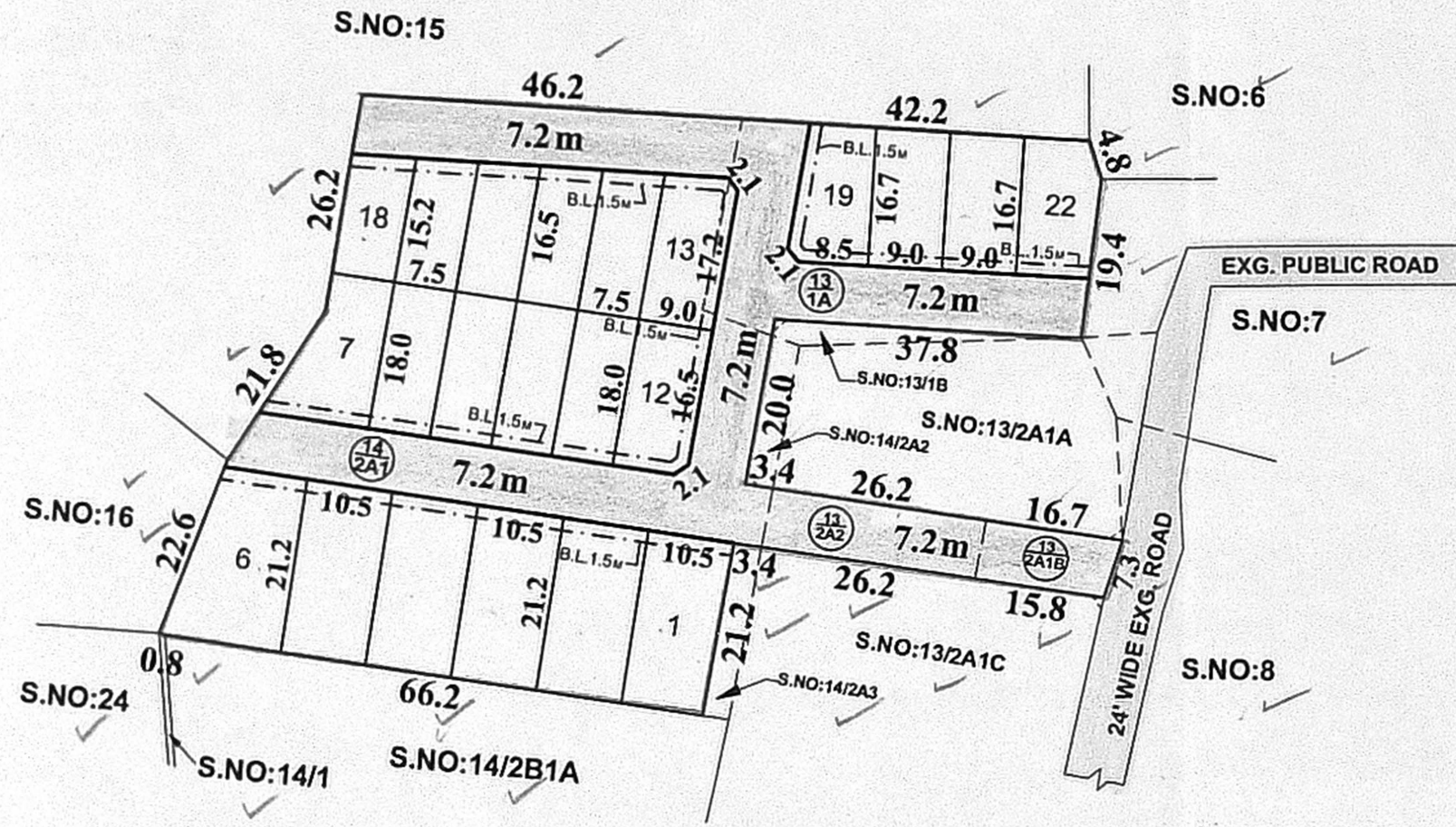

**CONDITIONS:**

THE LAYOUT APPROVED IS VALID SUBJECT TO OBTAINING SANCTION FROM THE LOCAL BODY CONCERNED.

P.P.D NO : 28  
 L.O 2018

**APPROVED**

VIDE LETTER NO : L1/8370/2017

DATED : 04/05/2018

*S. S. S. S.*  
 04/05/2018  
 FOR MEMBER SECRETARY  
 CHENNAI METROPOLITAN  
 DEVELOPMENT AUTHORITY

*S. M. S. S. S.*  
 25/04/18  
 PREPARED BY P.A.IV (S.M)

*S. S. S. S.*  
 25/04/2018  
 CHECKED BY P.A.II (A.A)

*S. S. S. S.*  
 25/04/2018  
 A.P.(S.A)

**POONAMALLEE PANCHAYAT UNION**

LAYOUT OF HOUSE SITES IN S.No: 13/1A, 2A1B, 2A2, 14/2A1 OF GOPARASANALLUR VILLAGE.

SCALE : 1:800 (ALL MEASUREMENTS ARE IN METRE.)

